

RCE-EC



Description

RCE Q-SW-EC: cross-flow heat recovery units

- 80% efficiency
- aluminium exchange pack
- casing in galvanised steel
- execution with double panelling filled with acoustic foam 40 Kg/m³ density
- single-phase EC high efficiency fans
- temperature probes
- differential pressure switches for filters
- automatic motorised by-pass
- M6 (ISO ePM10 70%) and F7 (ISO ePM1 50%) filters, removable on both sides
- condensate drip tray
- configuration can be modified at installation site (standard D3/D6)

Remote control with LCD (included):

- backlit
- dirty filters warning light
- RS485 port
- can be installed up to 200m from the unit
- 2 manual functions
- 2 automatic functions

Accessories

- hot and cold water coil
- 230 Volt electric coil with thermostat (on request)
- cover for outdoors
- spigot with wire mesh
- additional external filter modules, flat filters and rigid pockets (on request)

Ceiling mounted horizontal configuration

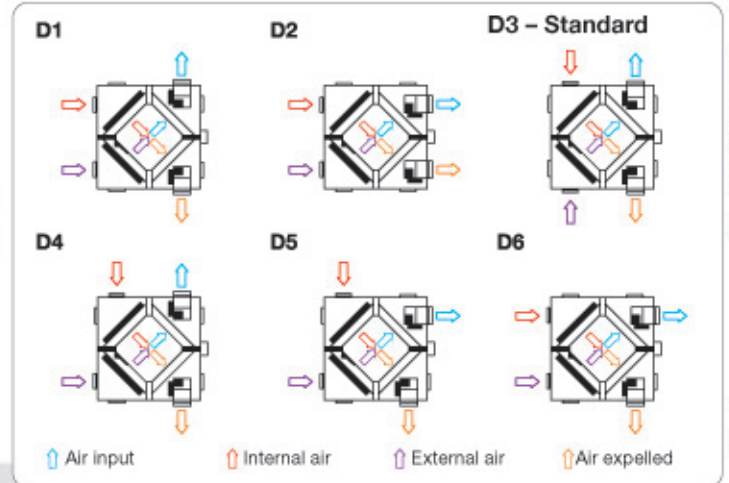

Vertical configuration

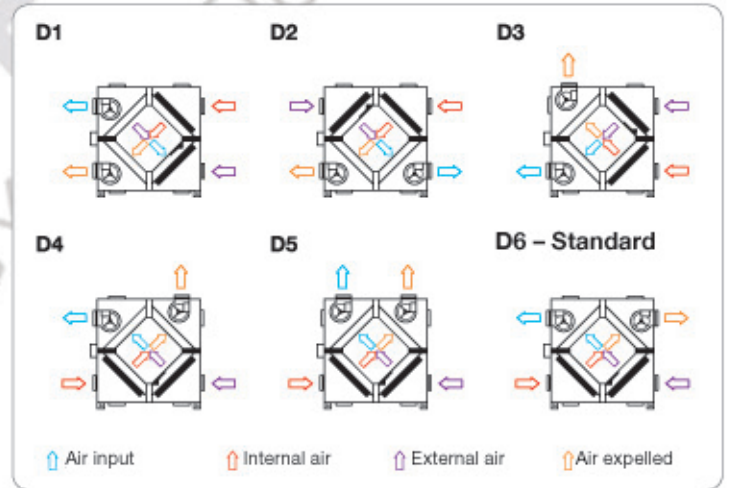

Heat recovery units / VMC / Air treatment

Selection table

Model	Flow rate	Voltage	Nom. kW	DN connection
500	500	230	0.24	150
700	750	230	0.24	150
1200	1200	230	0.55	180
1600	1600	230	0.55	250
2000	2000	230	0.75	315
2300	2300	230	2.15	315
2800	2800	230	2.15	315
3200	3200	230	2.08	315
3800	3800	230	2.08	350
4500	4500	230	2.58	350
4900	4900	230	3.64	350
5400	5400	230	4.40	350
6500	6500	230	4.62	450
7100	7100	230	4.74	600
8500	8500	230	4.76	600

Accessories

kW	kW
3.46	0.93
4.16	1.38
8.30	3.60
11.10	4.73
18.20	7.50
15.90	6.53
19.40	8.37
22.10	9.51
26.30	11.00
31.10	13.10
33.90	15.10
37.30	16.80
41.50	18.40
49.10	21.50
55.30	24.30

Heat recovery unit including remote control (LCD). The control and electronic board manage both the water and electric coil.

1: inlet/outlet water temperature: 70/60°C
air inlet/outlet temperature: 10/30°C
2: inlet/outlet water temperature: 12/17°C
air inlet/outlet temperature: 30/25°C

Heat recovery units / VMC / Air treatment

Dimensions - Horizontal configuration

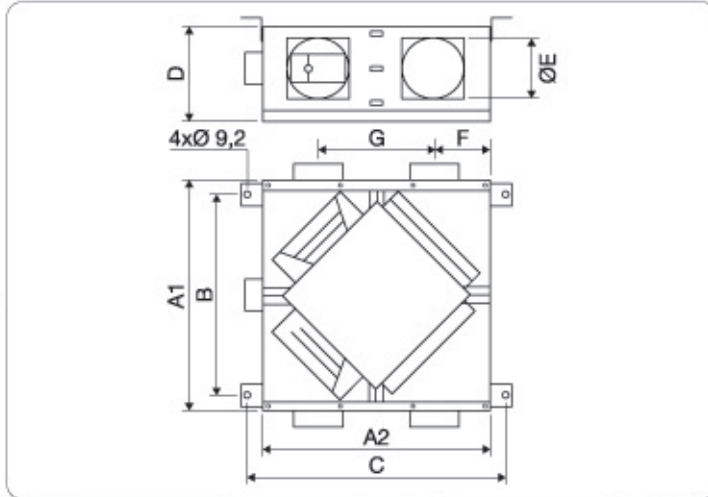

Dimensions - Vertical configuration

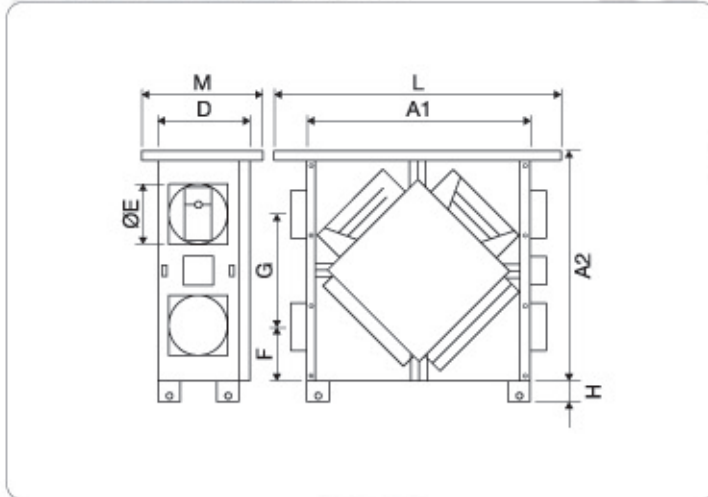

Mod.	A1	A2	B	C	D	ØE	F	G	H	L	M	Kg Horiz.	Kg Vert.
500	850	850	755	910	380	150	175	500	100	1050	450	55	57
700	1000	1000	905	1060	380	150	250	500	100	1200	450	64	66
1200	1000	1000	905	1060	380	180	200	600	100	1200	450	80	86
1600	1200	1200	1105	1260	525	250	300	600	100	1450	610	110	117
2000	1200	1200	1105	1260	525	315	275	650	100	1450	610	110	117
2300	1200	1200	1105	1260	525	315	275	650	100	1450	610	124	135
2800	1350	1350	1255	1410	575	315	300	750	100	1650	670	161	167
3200	1350	1350	1255	1410	675	350	300	750	100	1650	770	178	183
3800	1350	1350	1255	1410	675	350	325	700	100	1650	770	188	208
4500	1350	1350	1255	1410	775	350	300	750	100	1550	850	215	245
4900	1350	1350	1255	1410	775	350	325	700	100	1550	850	215	245
5400	1650	1650	1080	1710	775	350	285	1080	100	1900	850	302	340
6500	1650	1650	1080	1710	775	450	355	940	100	1900	1000	302	340
7100	2170	2170	-	-	1110	600	435	1300	100	2200	1130	500	550
8500	2170	2170	-	-	1110	600	435	1300	100	2200	1130	500	550

Erp 2018 - EU 1253/2014					
Flow rate (m³/h)	Prev. (Pa)	Yield¹ (Eff. %)	Noise level on output² (dBA)	Noise level 1 metre³ (dBA)	Noise level 3 metres³ (dBA)
520	88	71.8	79	52	46
720	37	73.7	70	53	47
1120	54	75.1	82	55	48
1580	25	75.3	84	56	50
1780	365	74.6	86	58	52
1780	365	74.6	86	58	52
2160	406	74.7	85	61	53
2540	412	74.7	80	61	54
2760	381	74.8	80	62	56
2680	481	74.6	92	63	57
3360	570	74.9	83	64	58
4780	511	74.9	84	64	60
4880	669	74.8	87	65	62
5140	700	74.7	89	67	62
6460	445	76.6	82	67	61

1: thermal efficiency of exchange pack 20°C dry
 2: total sound power of fans at maximum flow rate, non-ducted
 3: sound pressure, measured at 1 m and 3 m from the machine casing, at maximum range, ducted outlets

500Q-SW-EC RCE

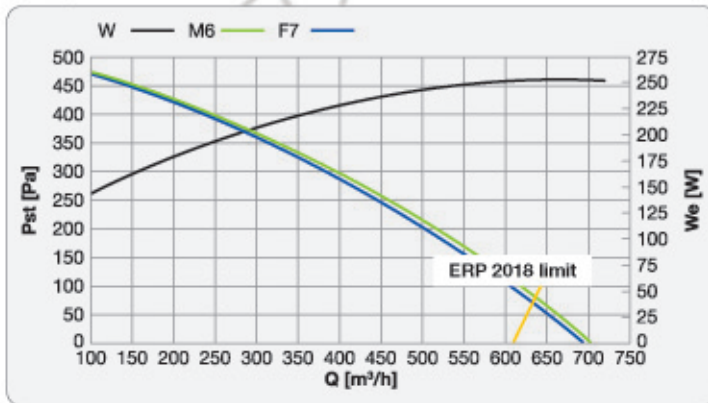

700Q-SW-EC RCE

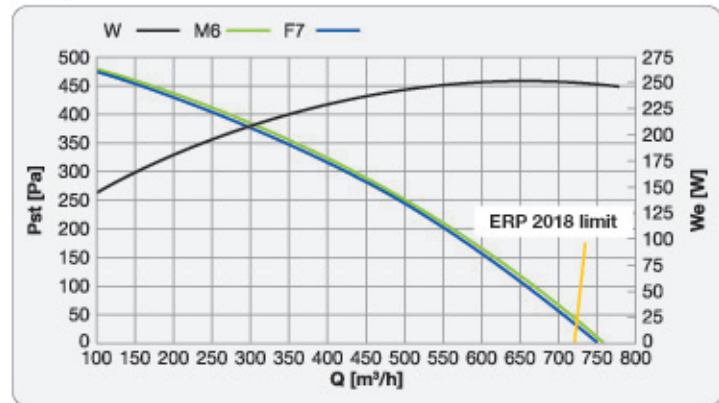

1200Q-SW-EC RCE

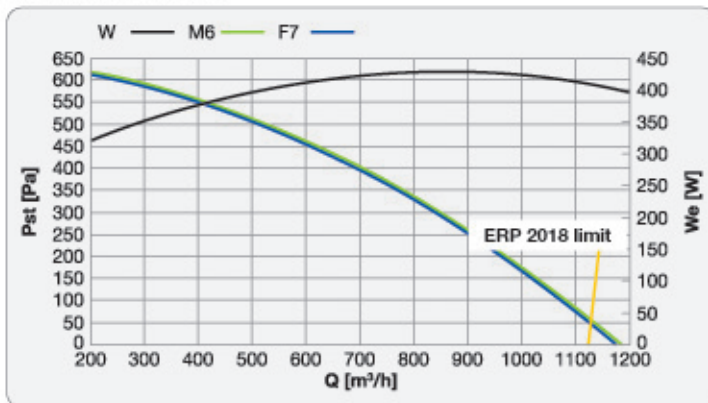

1600Q-SW-EC RCE

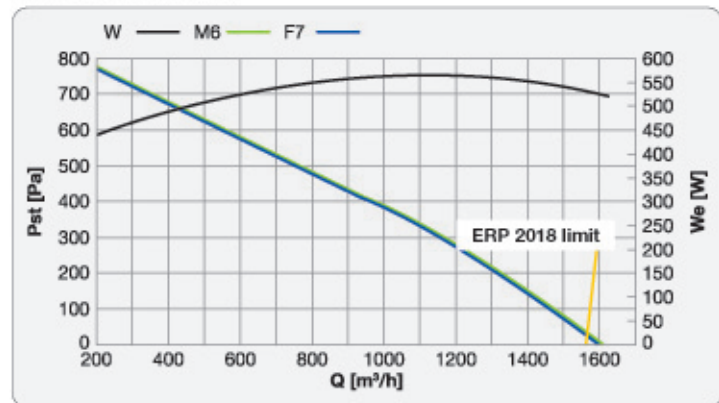

2000Q-SW-EC RCE

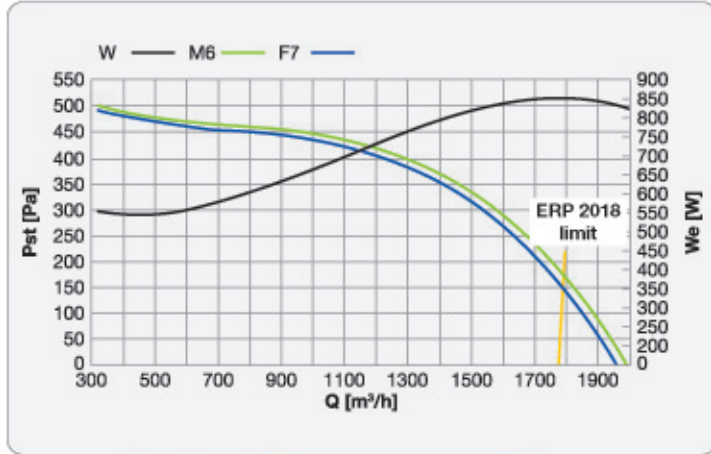

2300Q-SW-EC RCE

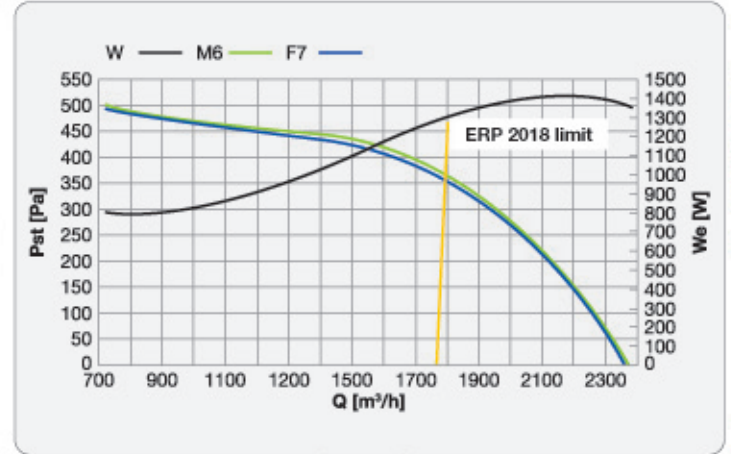

2800Q-SW-EC RCE

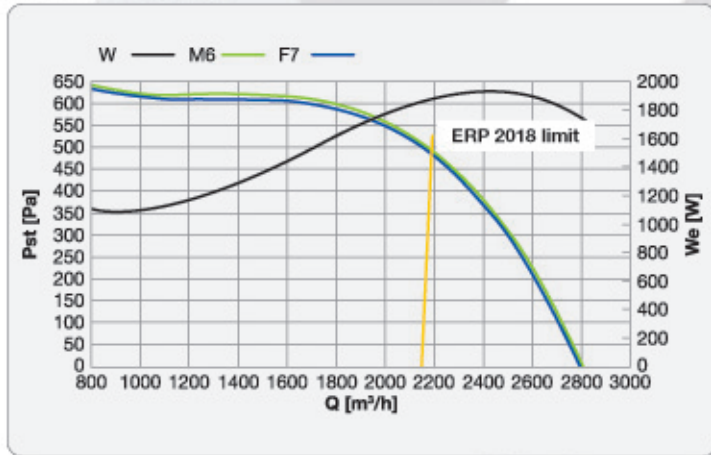

3200Q-SW-EC RCE

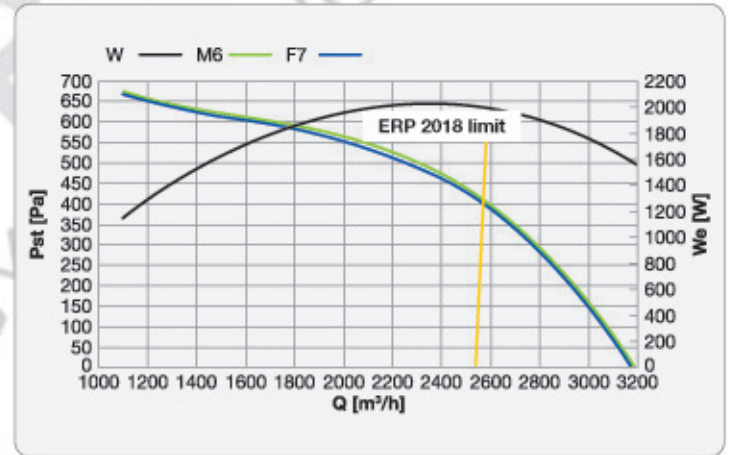

3800Q-SW-EC RCE

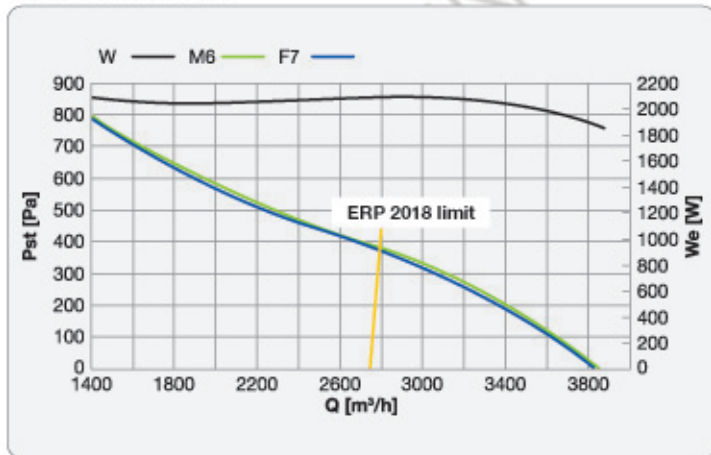

4500Q-SW-EC RCE

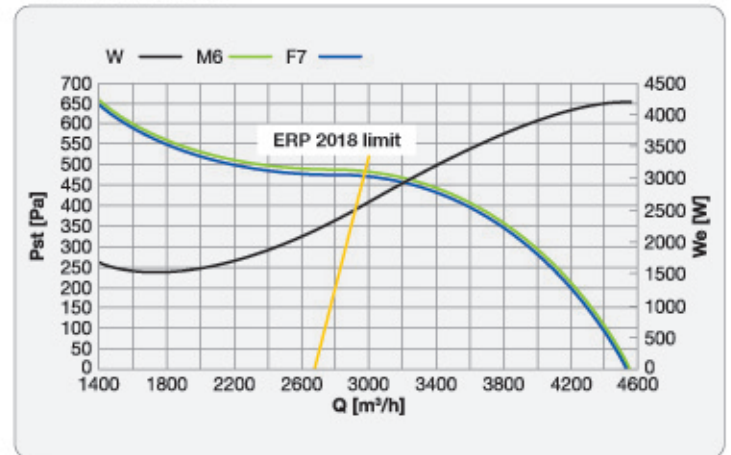

4900Q-SW-EC RCE

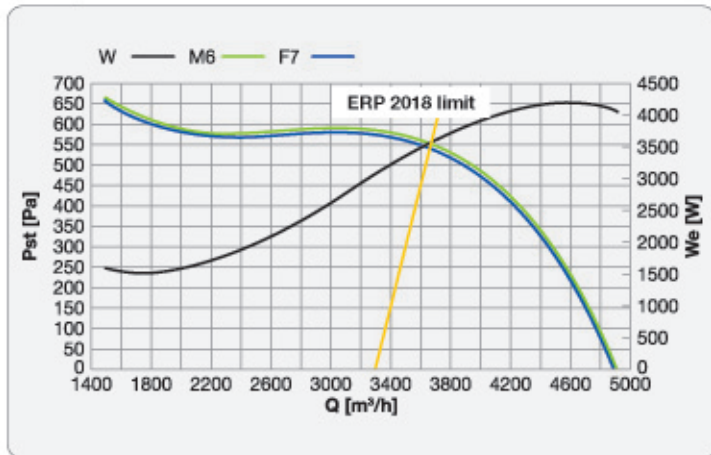

5400Q-SW-EC RCE

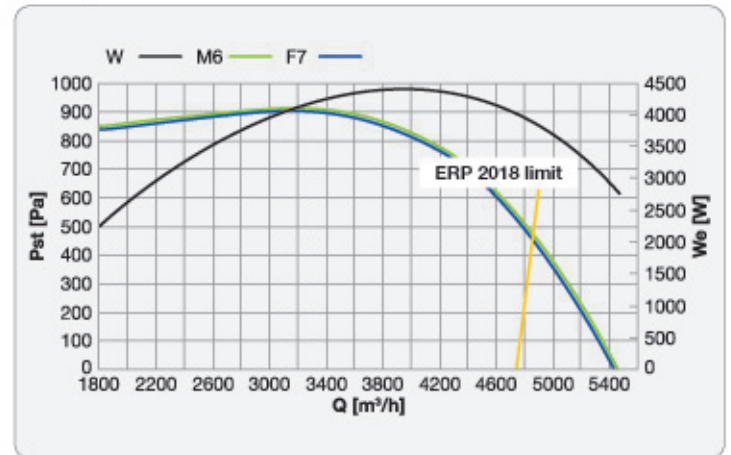

Heat recovery units / VMC / Air treatment

Spare filter

Model	Number of filters per side	Dimensions (mm)
500	1	450x340x25
700	1	450x340x25
1200	1	450x340x25
1600	1	500x400x48
2000	1	625x500x48
2300	1	625x500x48 ¹
2800	1	625x500x48
3200	1	625x600x48 ²
3800	1	625x600x48 ²
4500	1	625x700x48
4900	1	625x700x48
5400	2	800x350x48 ³
6500	2	800x350x48 ³
7100	3	800x350x48 ⁴
8500	3	800x350x48 ⁴

1: from September 2019

2: from January 2018

3: from July 2018

4: from July 2019