

Fans

PP



### Description

PP: centrifugal fan to extract air in corrosive environments

- polyethylene housing
- polypropylene moulded impeller
- powder-coated galvanised steel structure
- three-phase gear motor 220/380/50Hz
- screws in AISI 304/316 stainless steel
- operating temperature -40°C / +70°C

### Accessories

PMR: spigot with polypropylene mesh

PST: polypropylene volume control damper

PSS: polypropylene gravity damper

### Special executions

PPEExd: EExd blast-proof three-phase motor version ATEX 2G ZONES 1 – 2 GD ZONE 21 – 22

X: motor support in AISI 304/316 stainless steel

A: anti-static housing

Note: Always specify the orientation

Type	kW	rpm	rpm	A	B	ØD	E	F	G	H	I	L	M	N	P	Q	R	Kg
20	0.12	1370		140	180	160	150	138	60	370	250	190	100	195	95	140	225	10
	0.18	2750										190						
25	0.12	1370		183	228	200	180	170	80	465	310	190	100	252	110	140	282	10
	0.37	2820										210						12
28	0.16	1370		208	255	225	190	190	80	520	350	190	120	277	120	190	312	17
	0.75	2820										232						22
31	0.25	1400		240	280	250	200	210	80	580	410	210	150	315	140	230	350	23
	1.50	2850										245						31
35	0.37	1400		260	312	280	220	230	80	640	445	210	150	345	150	230	380	28
	2.20	2870										270						38
40	0.55	1420		290	352	315	240	264	80	723	495	232	170	325	160	250	425	38
	0.25	920										210						34
45	1.10	1420		324	392	355	265	290	80	810	550	245	170	370	173	250	470	46
	0.37	920										232						37

### Orientation

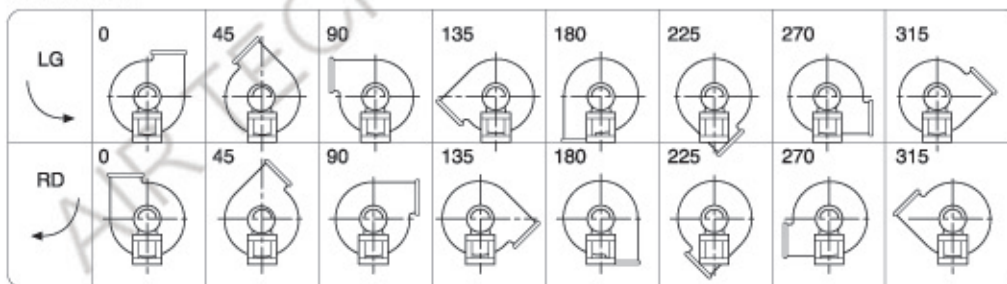

### Dimensions

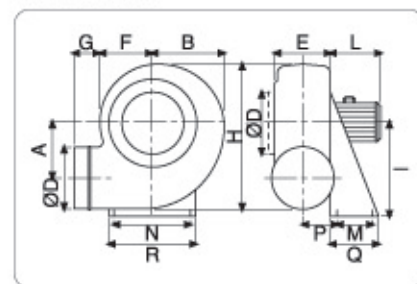

### Selection table

GR	Motor	kW	no.	LP	Q= m³/h																				
					480	540	600	720	840	960	1080	1200	1320	1500	1680	1860	2100	2400	3000	3360	3780	4260	4800	5400	6000
					mm H <sub>2</sub> O																				
P 202	63 A2	0.18	2750	62	45	43	42	38	31	23	13														
P 252	71 A2	0.37	2850	71			75	75	74	72	69	67	64	60	54	45	32								
P 282	80 A2	0.75	2850	75					110	110	109	106	100	95	91	88	80	67	47	30					
P 312	90 S2	1.50	2860	79								132	132	131	130	126	121	113	98	87	70	50			
P 352	90 L2	2.20	2870	80											170	170	168	160	148	146	130	115	96	80	
P 254	63 A4	0.12	1370	54	15	14	14	12	10	7	5														
P 284	63 B4	0.18	1370	55	24	23	23	22	20	18	16	14	12	8											
P 314	71 A4	0.25	1400	59			29	29	28	28	27	25	24	21	19	16	9								
P 354	71 B4	0.37	1400	61					38	38	37	36	36	35	33	30	28	23	13						
P 404	80 A4	0.55	1410	69								52	52	51	50	50	48	45	39	35	30	24			
P 454	90 S4	1.10	1410	70											65	65	64	63	59	53	51	46	41	31	19
P 316	71-6	0.18	930	48	14	13	13	12	11	9	8	7	6												
P 356	71-6	0.18	930	52			17	17	16	16	15	14	13	11	10	9									
P 406	71 B6	0.25	920	56						24	24	23	22	21	20	19	17	14							
P 456	80 A6	0.37	920	59								29	29	28	28	27	26	24	20	17	14				