

HOT WATER COILS

Description

- casing in galvanised steel
- copper piping
- aluminium blades

Special executions

Other executions on request

Dimensions

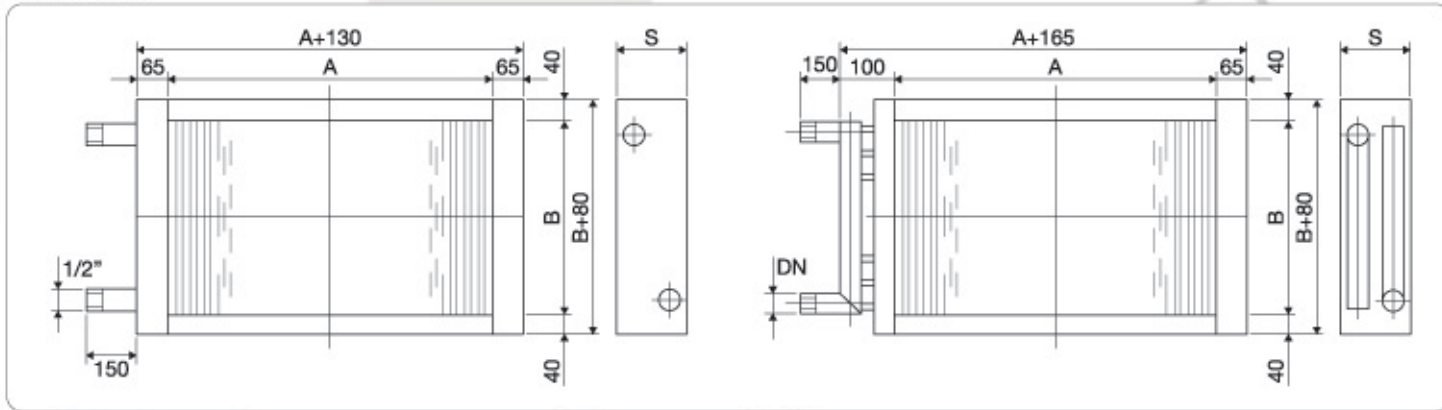

Selection table

Air flow (m ³ /h)	Air Ti (°C)	Air To (°C)	Air Δp (Pa)	Water flow (l/s)	Water Ti (°C)	Water To (°C)	Water Δp (kPa)	Power (kW)	Ø water	AxB (mm)	S (mm)	BxH (mm)	Coil pitch type
500	16	32	90	0.07	75	65	1	2.73	1/2"	300x120	130	430x200	P40 16 2R 3T
		32	116	0.07	60	50	1.1	2.73	1/2"		130	430x200	P40 16 2R 3T
		32	223	0.07	45	35	1.7	2.73	1/2"		190	430x200	P40 16 4R 3T
1000	16	32	74	0.13	75	65	5.1	5.47	1/2"	400x200	130	530x280	P40 16 2R 5T
		32	93	0.13	60	50	5.4	5.47	1/2"		130	530x280	P40 16 2R 5T
		32	143	0.13	45	35	7.5	5.47	1/2"		160	530x280	P40 16 3R 5T
1500	16	32	103	0.2	75	65	11.5	8.2	1/2"	500x200	130	630x280	P40 16 2R 5T
		32	126	0.2	60	50	11.9	8.2	1/2"		130	630x280	P40 16 2R 5T
		32	241	0.2	45	35	21.3	8.2	1/2"		190	630x280	P40 16 4R 5T
2000	16	32	94	0.27	75	65	24.7	10.94	1/2"	500x280	130	630x360	P40 16 2R 7T
		32	109	0.27	60	50	25.6	10.94	1/2"		130	630x360	P40 16 2R 7T
		32	223	0.27	45	35	7.7	10.94	1"		190	605x360	P40 16 4R 7T
2500	16	32	101	0.33	75	65	6.9	13.67	1"	600x280	130	705x360	P40 16 2R 7T
		32	124	0.33	60	50	7.2	13.67	1"		130	705x360	P40 16 2R 7T
		32	238	0.33	45	35	12.4	13.67	1"		190	705x360	P40 16 4R 7T
3000	16	32	74	0.4	75	65	12.2	16.41	1"	600x400	130	705x480	P40 16 2R 10T
		32	87	0.4	60	50	12.7	16.41	1"		130	705x480	P40 16 2R 10T
		32	143	0.4	45	35	18.2	16.41	1"		190	705x480	P40 16 3R 10T
3500	16	32	74	0.47	75	65	17.2	19.14	1"	700x400	130	805x480	P40 16 2R 10T
		32	87	0.47	60	50	17.9	19.14	1"		130	805x480	P40 16 2R 10T
		32	143	0.47	45	35	25.7	19.14	1"		160	805x480	P40 16 3R 10T
4000	16	32	94	0.53	75	65	21.9	21.88	1"	700x400	130	805x480	P40 16 2R 10T
		32	109	0.53	60	50	22.7	21.88	1"		130	805x480	P40 16 2R 10T
		32	223	0.53	45	35	14.4	21.88	1"		190	805x480	P40 16 4R 10T
4500	16	32	77	0.6	75	65	30.8	24.61	1"	800x440	130	905x520	P40 16 2R 11T
		32	91	0.6	60	50	32.1	24.61	1"		130	905x520	P40 16 2R 11T
		32	149	0.6	45	35	16.3	24.61	1"		160	905x520	P40 16 3R 11T
5000	16	32	93	0.66	75	65	14.9	27.35	1"	800x480	130	905x560	P40 16 2R 12T
		32	153	0.66	60	50	21.1	27.35	1"		160	905x560	P40 16 3R 12T

Key:

Air Ti: air inlet temperature

Air To: air output temperature

Air Δp1: air side pressure drop at a flow rate of 40% of the nominal rate

Air Δp2: air side pressure drop at a flow rate of 80% of the nominal rate

Water Ti: water inlet temperature

Water Tu: water outlet temperature

Power: power in kW

AxB: coil air passage

S: coil depth

BxH: external flange dimensions