

Description

DGV: high induction diffuser

- installation height between 3 and 7 m
- individually adjustable blades
- external aluminium body, steel blades + equaliser
- RAL 9010 finish

DGVA: like DGV but with synchronised movement of the blades

DGV...T: including 596x596 panel for installation on false ceiling

Accessories

R1: with proportional actuator 0÷10V, 24V

R2: with on-off actuator, 24V

R3: with on-off actuator, 230V

PL: side entry plenum

I: external insulation reaction to fire class B-s2-d0

S: damper on entry 160/315 €20 - 400/630 €45

DGVA-ATS: thermostatic actuator

Special versions

VR: coating according to RAL 9005 / 9006 table
fixed surcharge €30 + 20% per piece

Other RAL colours on request

Dimensions

DN	D1	D2	H	H1	T	d	A	E
160	300	198	155	40	596	158	250	250
200	350	248	180	40	596	198	300	300
250	400	298	205	40	596	248	350	350
315	500	398	230	40	596	313	400	400
400	615	465	270	60	596	398	500	500
500	780	565	320	60	596	498	600	600
630	935	665	390	80	596	600	730	730

DGV

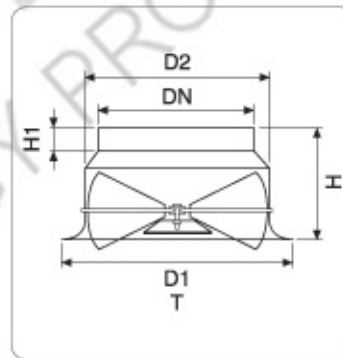

DGVPLS

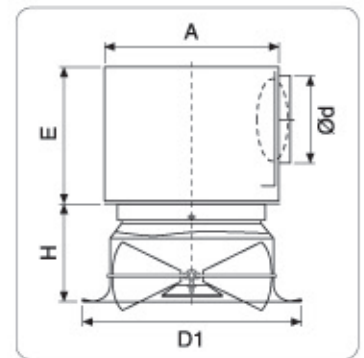

Rapid selection

DN	160	200	250	315	400	500	630
Flow rate (m ³ /h)	150 - 400	200 - 700	350 - 1000	500 - 1800	800 - 2500	1400 - 4000	2000 - 6000
Δpt* (Pa)	10 - 60	12 - 100	14 - 130	10 - 100	13 - 100	15 - 120	12 - 100
Lw(A)* dB(A)	32 - 55	30 - 56	26 - 48	29 - 55	32 - 55	31 - 56	30 - 55
Min. installation H (m)	3	3	3	3	3	4	5

* The pressure drop and noise level data are calculated with a 45° blade inclination
During the cooling phase, consider a blade inclination of between 45° and 55°

Selection diagrams

DN250

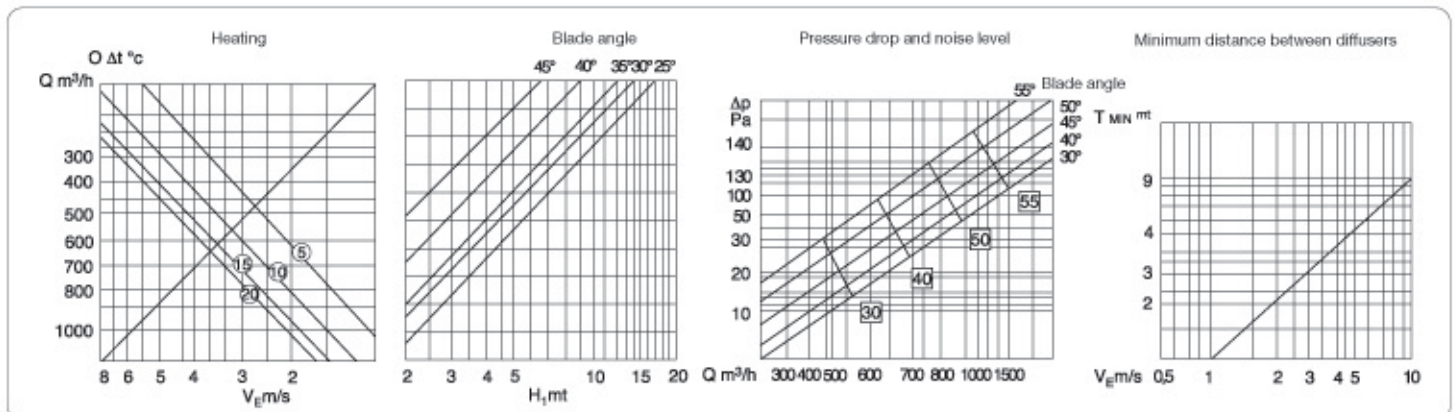

Key

Q (m³/h):	air flow	Tmin (m):	minimum distance between diffusers
H1 (m):	throw depth	Δpt (Pa):	pressure drop
VE (m/s):	diffuser outlet velocity	Lw(A) dB(A):	sound power level

Diffusion

Selection diagrams

DN315

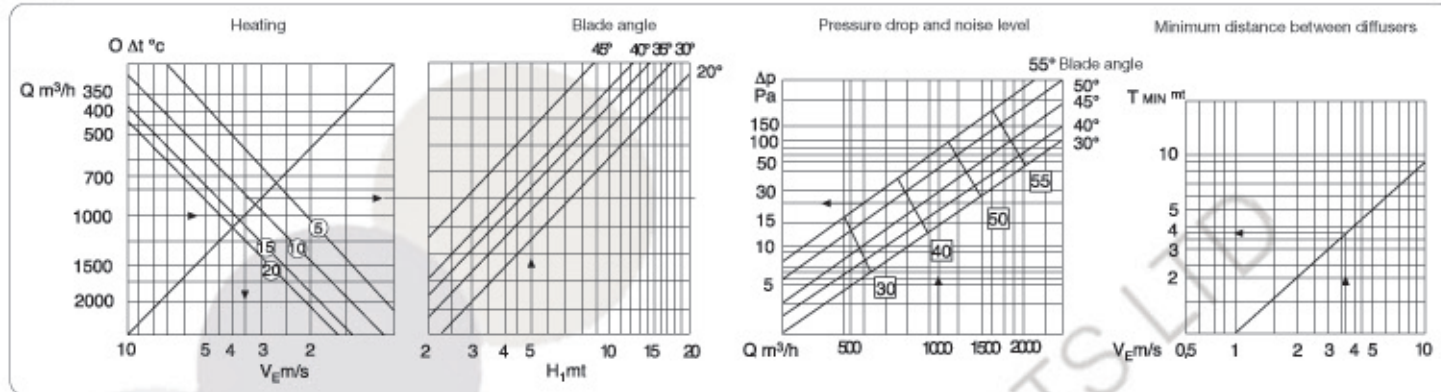

DN400

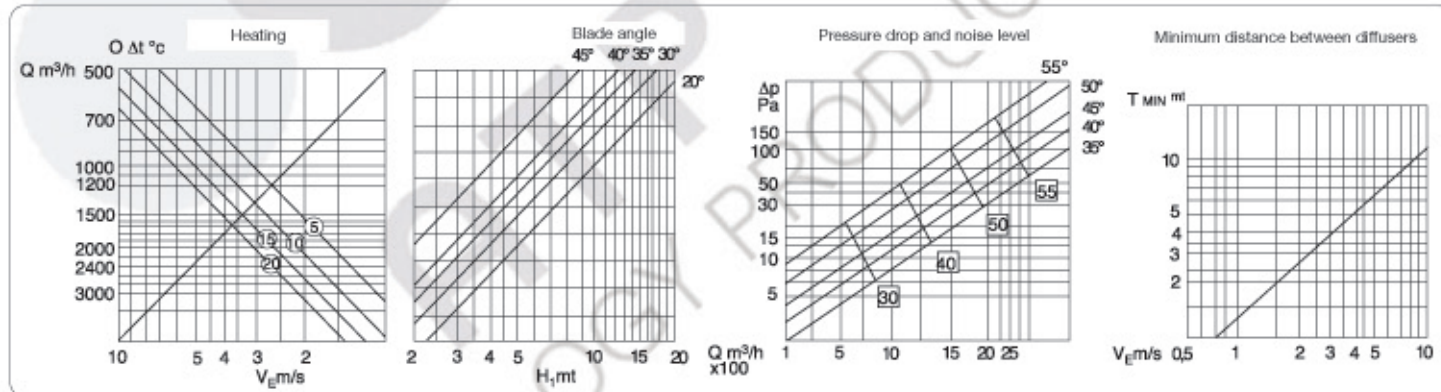

DN500

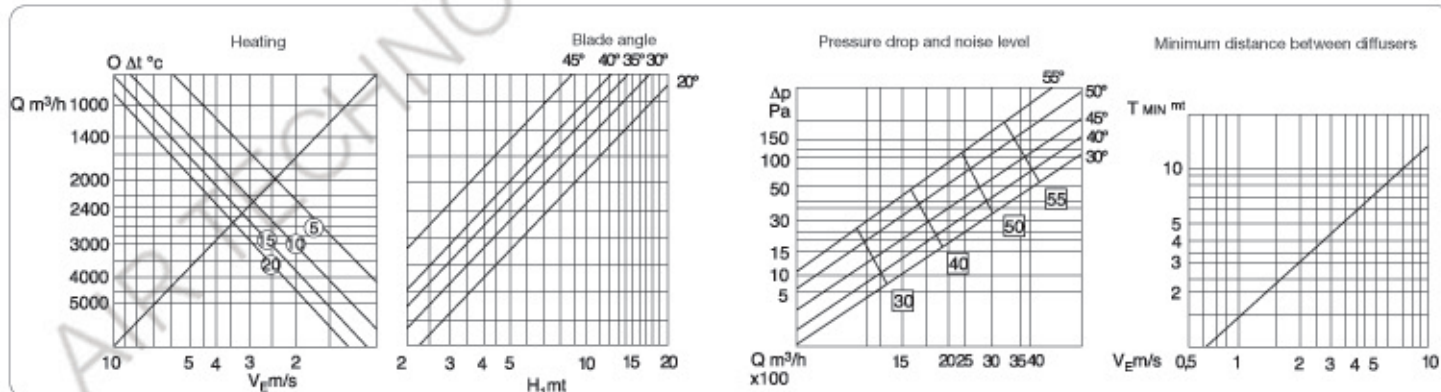

DN630

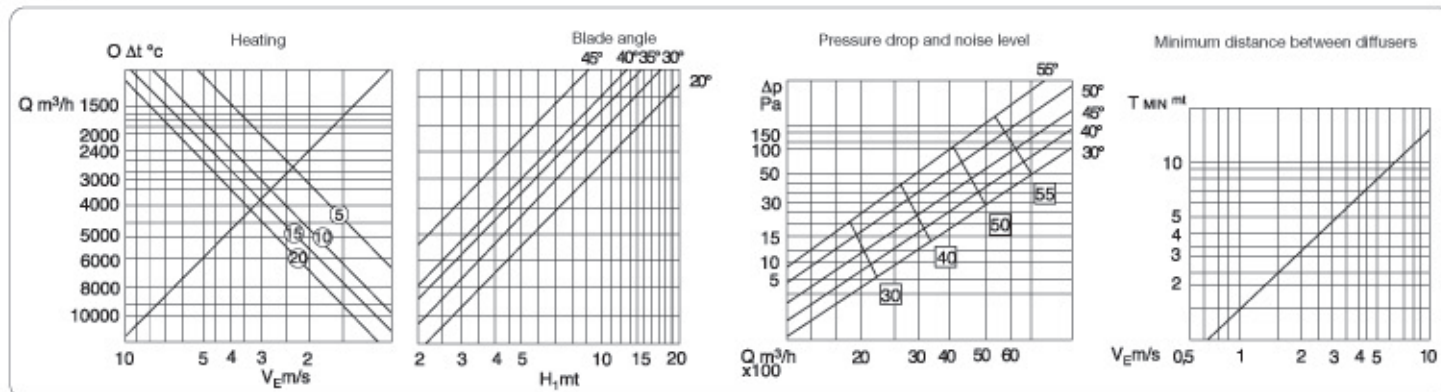

During the cooling phase, consider a blade inclination of between 45° and 55°