

Description

- DCR:** diffuser with adjustable cones
- adjustment with micrometric screw
 - removable central cones for easy assembly
 - made of aluminium with RAL 9010 finish

DCRQ: like DCR but with 596x596 panel

Accessories

- SF:** butterfly damper
- 2 blades up to 315 diameter (not for thermostatic actuators)
 - 4 blades for bigger diameters (not for thermostatic actuators)
- E:** equaliser
- SK:** deflector flap damper + equaliser (on request)
- KD:** plasterboard false ceiling fastening kit (list price €25)
- DCRQ-ATS / DCR-ATS:** thermostatic actuator

Special version

VR: coating according to RAL 9005 / 9006 table
fixed surcharge €30 + 20% per piece

Other RAL colours on request

Dimensions

DN	100	160	200	250	315	355	400	450	500	630
D	98	158	198	248	313	353	398	448	498	628
B	194	280	360	445	560	640	680	735	805	943
E	230	335	423	517	640	730	776	825	917	1045
A	75	105	118	130	146	185	185	185	185	185
C	30	45	48	48	48	65	65	65	65	65
F	198	288	370	461	576	656	700	755	825	963
Q	596	596	596	596	596	-	-	-	-	-
AQ	70	100	110	120	126	-	-	-	-	-

DCR

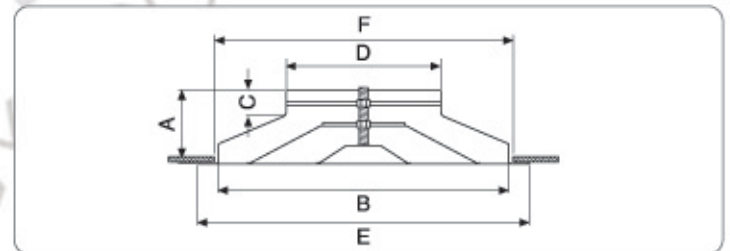

DCRQ

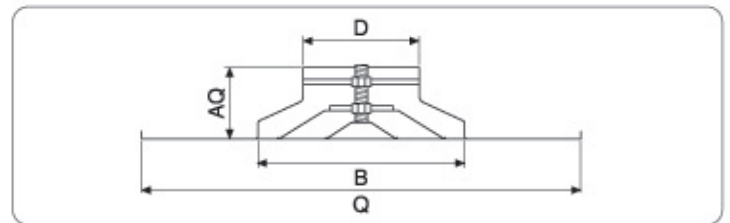

SF

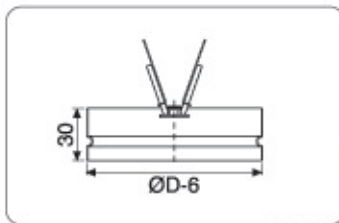

SK

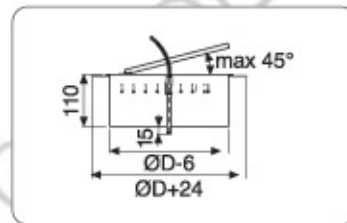

Selection table for DCR and DCRQ with $V_t = 0.25$ m/s

AK (dm ²)	DN (mm)	Flow rate (m ³ /h)																										
		200		250		300		400		500		600		800		1000		1250		1500		1750		2000		2500		
1.5	160	25	1.4	30	1.7	36	2.1	45	2.8																			
		3.7	14.0	4.4	20	5.6	33	7.2	54																			
2.7	200			18	1.3	23	1.5	30	2.1	36	2.6	42	3.2															
				2.5	6.6	3	10	4	17	5	26	6	38															
4.0	250					15	1.3	22	1.7	27	2.1	33	2.6	41	3.5	50	4.5											
						2	4.2	2.7	7.7	3.4	12	4	17	5.6	33	7	52											
5.6	315							15	1.5	20	1.8	25	2.2	34	3	40	3.7	47	4.6									
								2.0	4.2	2.4	6	3	10	4	17	5	26	6.2	40									
7.4	355									20	1.9	25	2.6	34	3.3	42	4.1	47	5									
										2.3	5	3	9	3.8	16	4.8	23	5.5	32									
9.0	400											20	2.3	28	3.0	35	3.8	41	4.5									
												2.5	6.5	3	9	3.8	16	4.6	22									
1.1	450																											
1.3	500																											
1.9	630																											

The NR values do not take into account room attenuation

K factor for vertical throw

$\Delta t(K)$	-10	0	+10	+20	v_k	Δp_k	NR
L_t	x2	x1.15	x0.80	x0.50	x1.15	x1.30	+4

K factors for other Vt

V_t	0.2	0.25	0.375	0.5
L_t	1.25	1	0.75	0.5

Profiles for false ceilings

Profiles for false ceilings

IT IS possible to produce some of our products with panel edges suitable for various types of false ceilings:

- DCRQ
- DEQ
- DQER/Q
- DMFQ
- DMUQ
- DQB4
- RSKP
- RSKO

L: Installation recommended for inspection panel

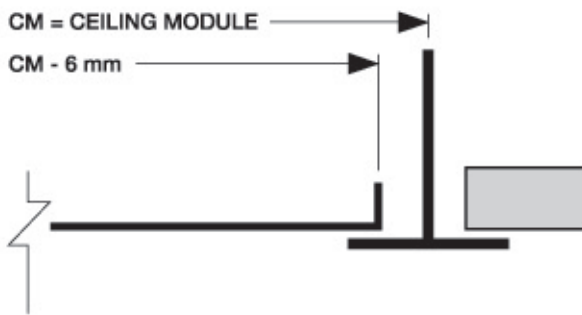

F: Fineline

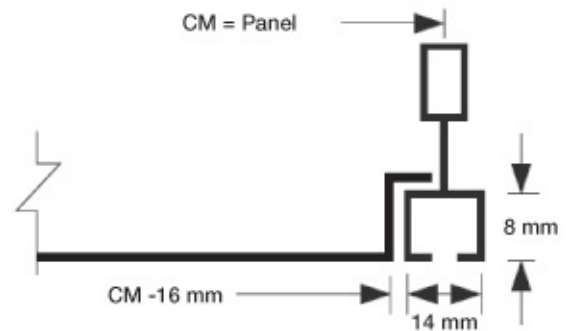

TL: tile (LAY-IN)

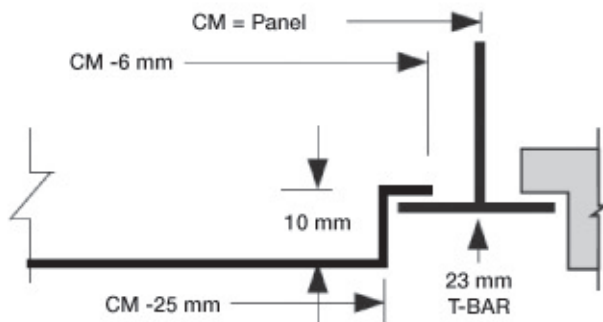

M (SNAP-IN)

